

# B1 Charcoal Grill

## CART & SHELF ASSEMBLY INSTRUCTIONS

This diagram illustrates all of the major components of the cart and how they relate to the final assembly.

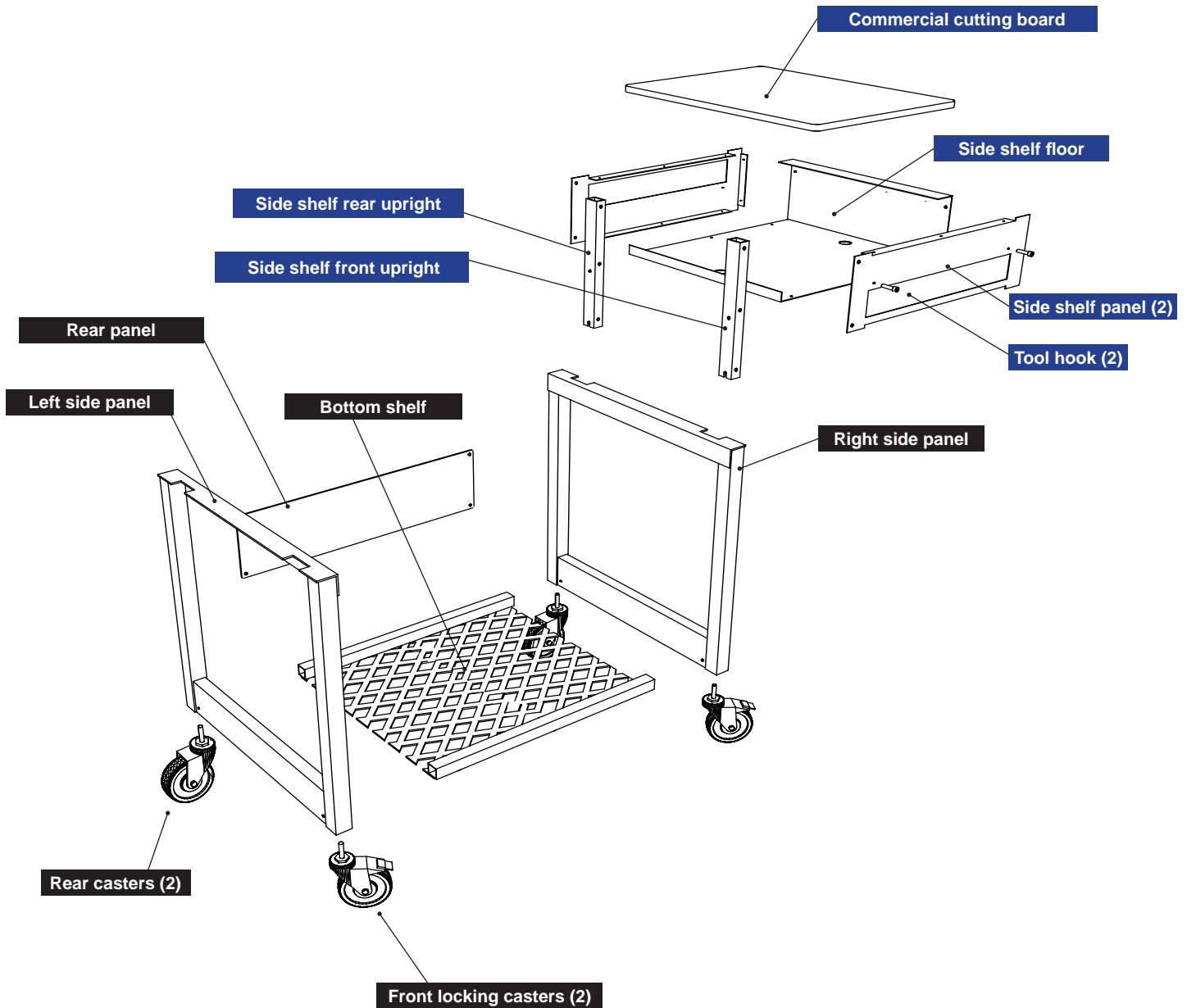

Exploded View of Cart and Shelf components

# CART ASSEMBLY INSTRUCTIONS

## ASSEMBLE THE CART or CABINET BEFORE YOU ASSEMBLE THE GRILL!

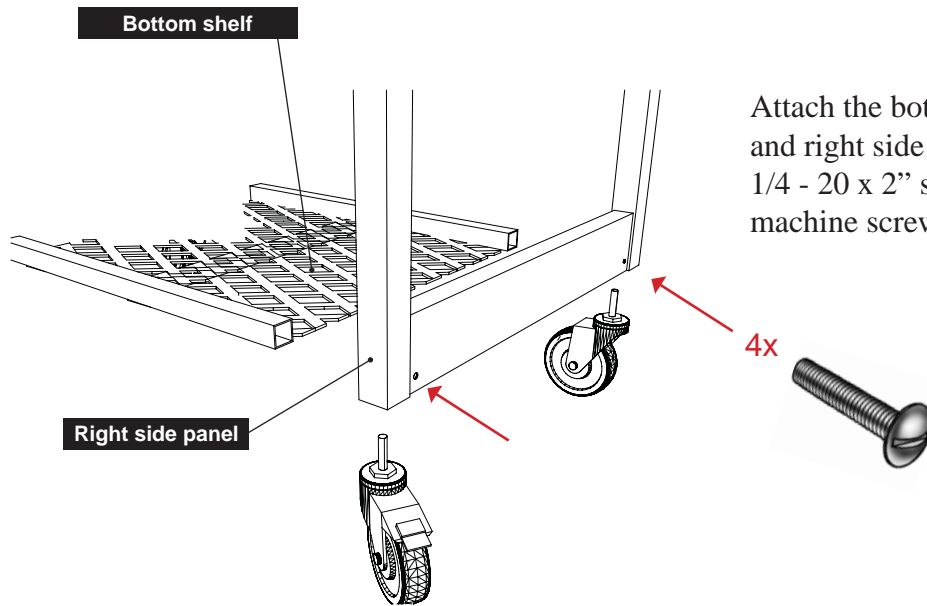

**1.**

Attach the bottom shelf to the left and right side panels using two 1/4 - 20 x 2" stainless truss head machine screws on each side.

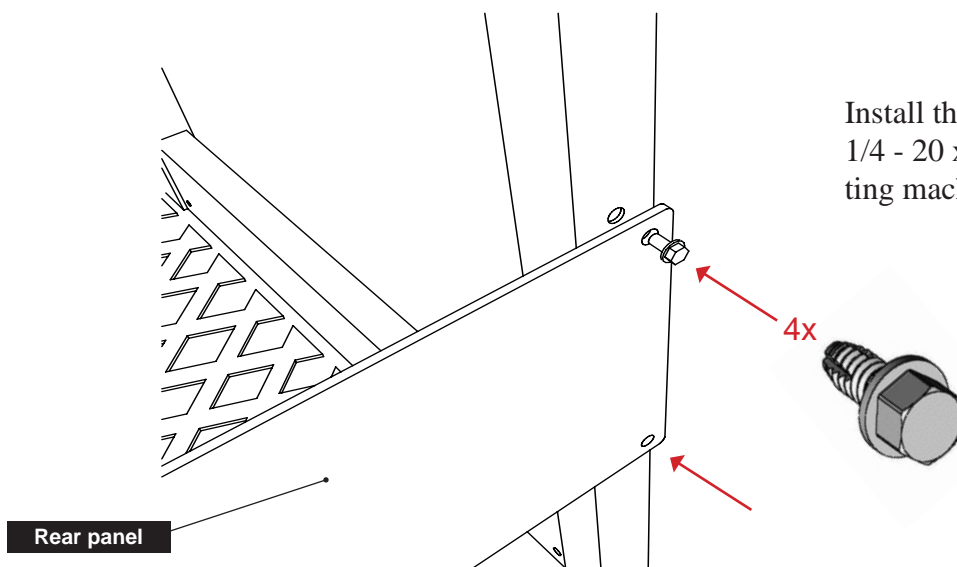

**2.**

Install the rear panel. using four 1/4 - 20 x 1/2" F type thread cutting machine screws.

## CART ASSEMBLY INSTRUCTIONS

### 3.

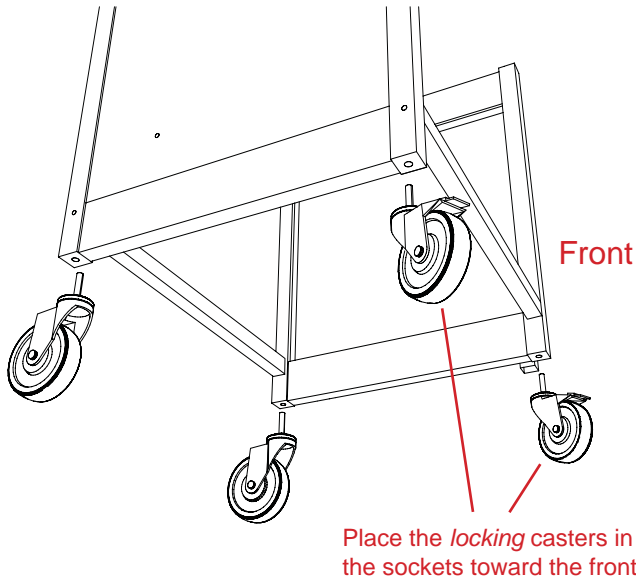

Place four casters into the sockets on the bottom of the cabinet legs

There are two locking casters and two non-locking casters. The locks prevent the wheels and the caster stem from rotating.

Most people place the locking casters on the front side of the cabinet so they are easier to see and operate, but you can install them any way you prefer.

### 4.

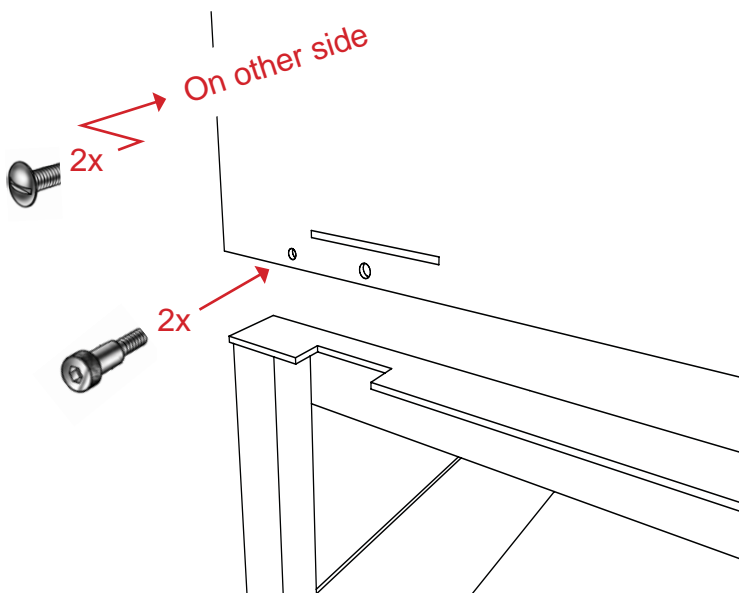

Place the firebox on the cart. **BE CAREFUL!** Get some help for this step. The firebox is heavy and you don't want to drop it, scratch it or hurt yourself.

Install two tool hook screws on the left side (this is where you hang the cooking grate when it's not in use).

Install two 1/4 - 20 x 1/2" truss head screws in the other side.

These four screws serve as set screws to keep the firebox in place.

## SIDE WORKTABLE ASSEMBLY INSTRUCTIONS

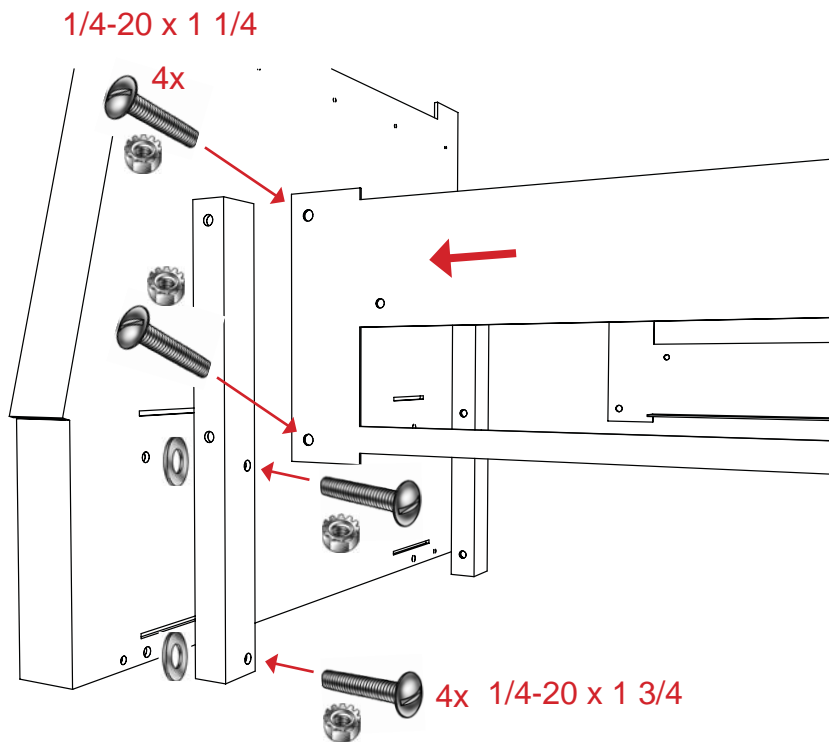

# 1.

Fasten two side shelf supports to the firebox using four 1/4-20 x 1 3/4 screws. Tighten the nuts inside the firebox. Make sure to place the four stainless washers between the uprights and the firebox.

The uprights must be mounted as shown. The holes are off-center, and the smaller spacing should be toward the inside.

Fasten the side shelf front and rear panels to the uprights using 1/4-20 x 1 1/4 screws and nuts.

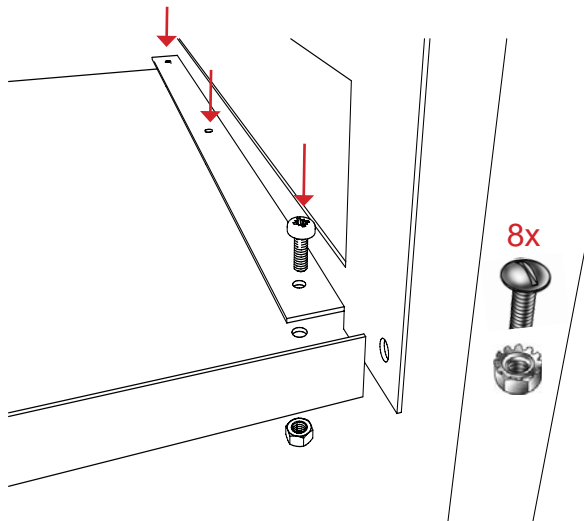

# 2.

Assemble the side shelf bottom panel to the side panels using eight 10-32 x 5/16 truss head screws and nuts.

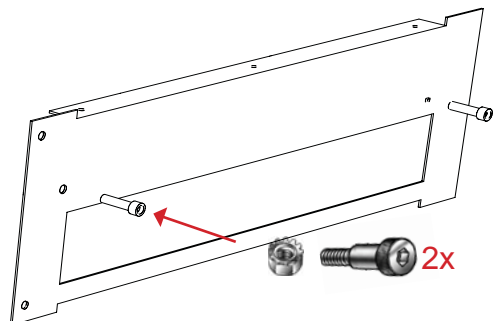

# 3.

Fasten the two tool hooks using 1/2" stainless shoulder bolts and 10-24 nuts.